

4

3

2

1

REVISIONS					
ZONE	LETTER	DESCRIPTION	DATE	CHECKED	APPROVED

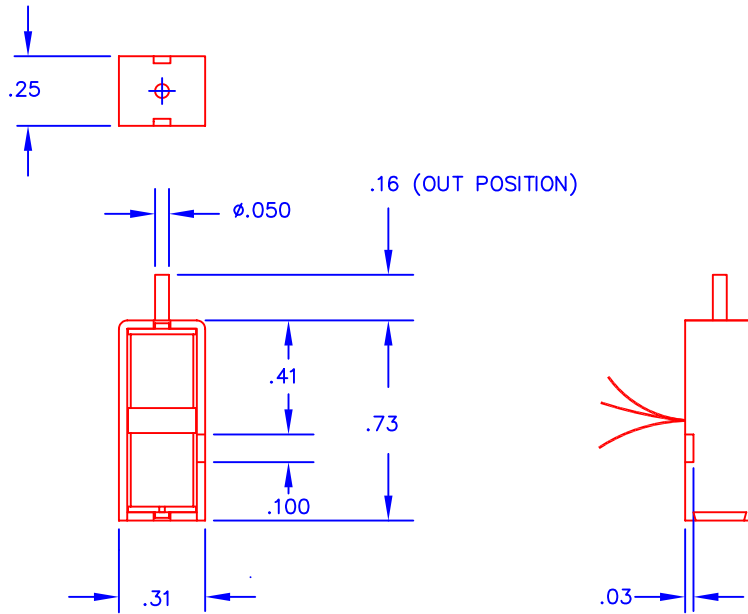

2-STROKE: .07 INCHES

1- BI-DIRECTIONAL MOTION CAN BE ACHIEVED BY PULSING EACH INDIVIDUAL COIL (4 LEADS), OR BY REVERSING THE PULSE WHEN THE TWO COILS ARE CONNECTED IN PARALLEL (2 LEADS) AS FOLLOWS:

INDIVIDUAL (4 LEAD) CONNECTION:

PULL: YELLOW TO POSITIVE (+), BROWN TO NEGATIVE (-)

PUSH: GREEN TO POSITIVE (+), GREY TO NEGATIVE (-)

PARALLEL (2 LEAD) CONNECTION:

PULL: GREEN & BROWN TO NEGATIVE (-), GREY & YELLOW TO POSITIVE (+)

PUSH: GREEN & BROWN TO POSITIVE (+), GREY & YELLOW TO NEGATIVE (-)

NOTES :
UNLESS OTHERWISE SPECIFIED

DIMENSIONS ARE IN INCHES TOLERANCES ON:	
DECIMALS	FRACTIONS
.XXX	.XX ±
±.005 ±	.010
UNLESS OTHERWISE SPECIFIED	
USED ON	NEXT ASSY
APPLICATION	

MATERIAL

FINISH

CONTRACT

DRN	11/20/97	B.S.
CHKD		
APPVD		
APPVD		

MAGNETIC SENSOR SYSTEMS

SOLENOID
BI-DIRECTIONAL / LATCHING

SIZE	CODE	DWG. NO.	REV.
B		S-73-3L	2
SCALE: 2 / 1		SHEET 1 OF 1	

4

3

2

1

D

C

B

A

D

C

B

A