

MAGNETIC SENSOR SYSTEMS

Tubular Electromagnet



Series E-66-38
0.38" DIA X 0.66"
[9.6 mm X 16.7 mm]

TOTAL WEIGHT: 0.20 OUNCES [5 GR]

duty cycle	1 (100%)	1/2 (50%)	1/4 (25%)	1/10 (10%)
maximum "ON" time, (Sec.)	∞	180	40	8
watts	0.6	1.2	2.4	6.0
approximate ampere turns	112	158	224	354

AWG number	resistance (Ω)	volts DC	volts DC	volts DC	volts DC
27	0.39	0.48	0.68	1.0	1.5
28	0.52	0.56	0.79	1.1	1.8
29	0.69	0.64	0.91	1.3	2.0
30	1.43	0.93	1.3	1.9	3.0
31	1.93	1.1	1.5	2.2	3.4
32	3.20	1.4	2.0	2.8	4.4
33	5.28	1.8	2.5	3.6	5.6
34	7.43	2.1	3.0	4.2	6.7
35	12.1	2.7	3.8	5.4	8.5
36	20.8	3.5	5.0	7.1	11.2
37	30.3	4.3	6.0	8.5	13.5
38	47.8	5.4	7.6	10.7	16.9
39	88.9	7.3	10.3	14.6	23.1
40	127	8.7	12.4	17.5	27.7
41	183	10.5	14.8	21.0	33.1
42	281	13.0	18.4	26.0	41.0

HEAT SINK: For proper heat dissipation, body of electromagnet should be mounted on an equivalent of 1.0" x1.0" x 1/16" metal plate in an unrestricted flow of air.

MAGNETIC SENSOR SYSTEMS

E-66-38

MECHANICAL DIMENSIONS

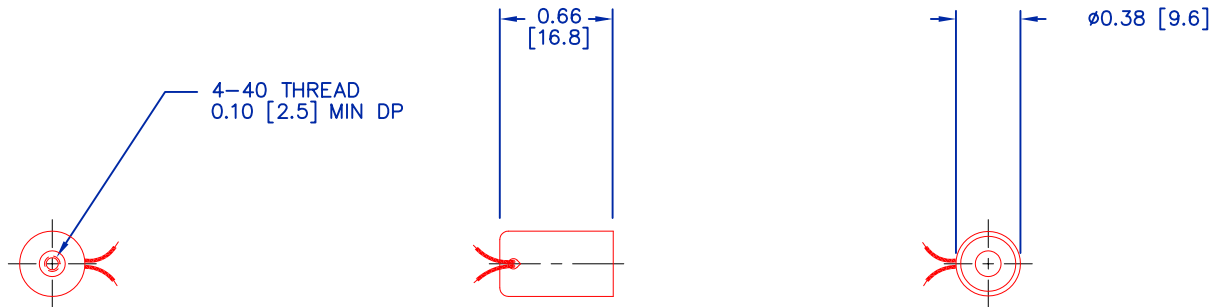

TOLERANCES: (UNLESS NOTED)

0.XXX: ±0.005

0.XX : ±0.010

X/X: ±1/64

COIL RESISTANCE: ±10%

DIMENSIONS IN INCHES [mm]

TYPICAL HOLD FORCE VERSUS INPUT POWER

